

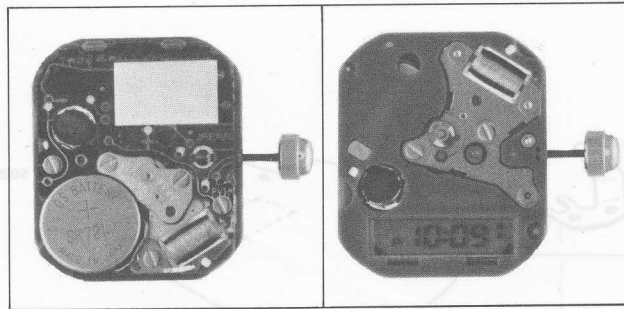

**Citizen 8960 Movement Parts (1)**

*Compiled by EmmyWatch - <https://www.emmywatch.com>*

Catalog No. 896-1~896-2



**896-1**  
(Catalog No.)

**896-2**  
(Catalog No.)

<b>8960-02</b>
<ul style="list-style-type: none"> <li>● Quartz crystal oscillator type</li> <li>  Analog display &amp; LC digital display</li> <li>[Analog]</li> <li>● Without center second</li> <li>  (20-sec. step movement)</li> <li>[Digital]</li> <li>● Time, Hour, Minute, Second</li> <li>● Calendar</li> <li>● Alarm</li> <li>● Chime</li> <li>● Timer</li> <li>● 12-24 hour switching function</li> </ul>
Thickness: 2.65mm <sup>t</sup>

EMPTYWATCH  
VINTAGE RESTORATIONS

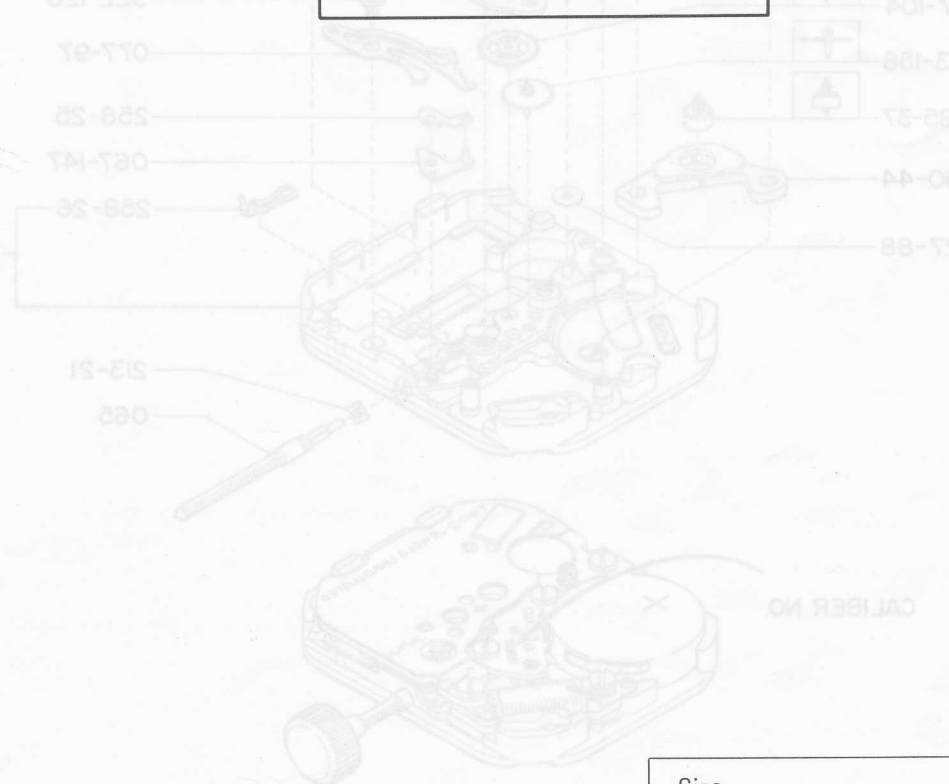

Size	20φ x 18 x 15mm
Vibration per second	32,768Hz

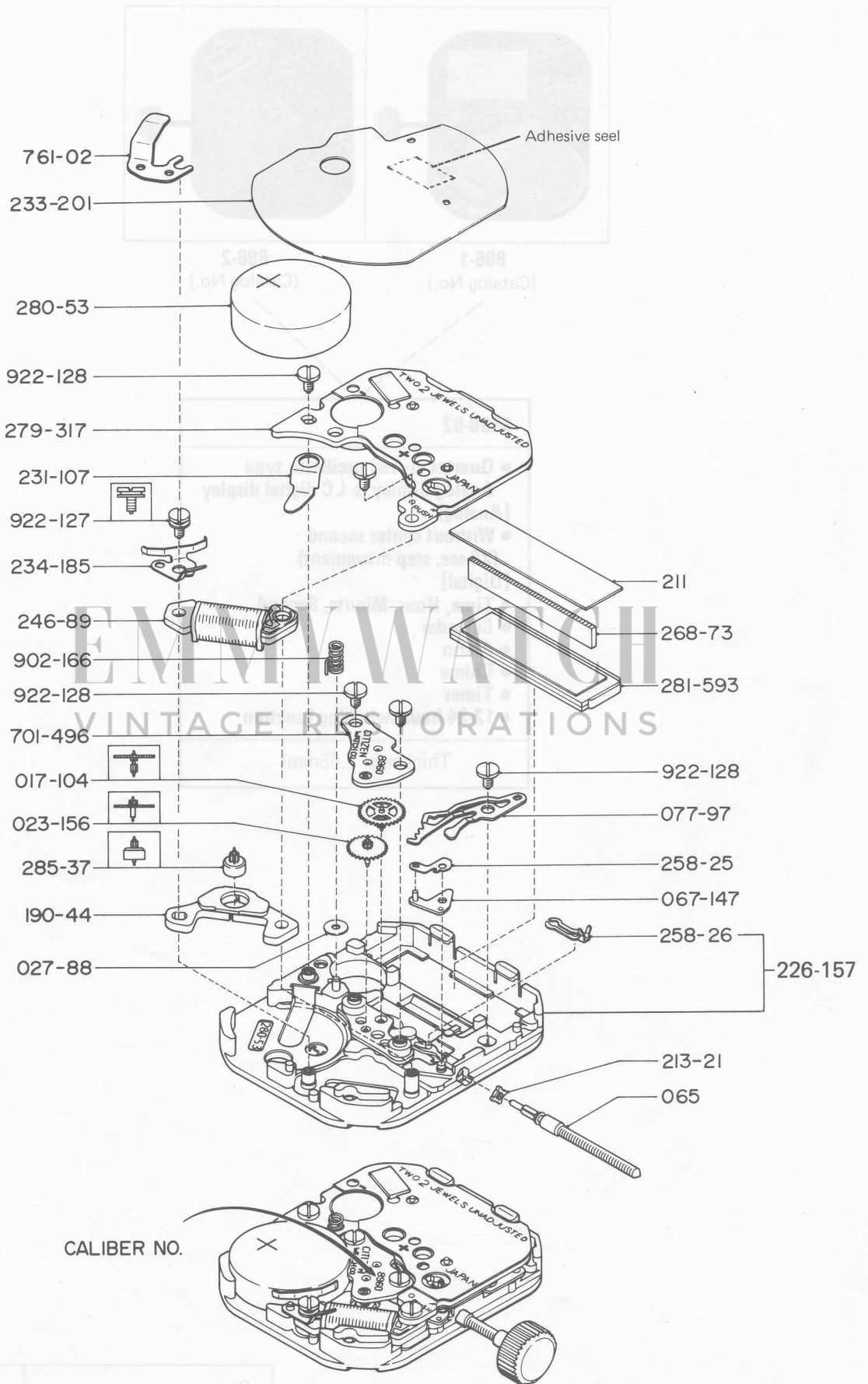

50 x 18 x 40 mm	Size
37,788 Hz	Vibration per second

[Power cell side]

Catalog No. 896-1

Parts No.	Name of parts	Caliber No.																		
		Nos. of jewels	8960	02																
017	3rd wheel & pinion	104																		
023	4th wheel & pinion	156																		
027	Washer for buzzer contact spring	88																		
065	Setting stem	296																		
065	Setting stem (Long size)																			
067	Setting lever	147																		
077	Setting lever spring	97																		
190	Stator	44																		
☆ 211	Reflecting plate (Silver)	109																		
☆ 211	Reflecting plate (Gold)	107																		
213	Switch wheel	21																		
226	LC display panel supporter	157																		(Already set to 258-26)
231	Power cell connector spring	107																		
233	Insulator sheet	201																		(With adhesive seal)
234	Power cell holder	185																		
246	Coil unit	89																		
258	Switch spring [I]	25																		
258	Switch spring [II]	26																		
268	LC display panel connection rubber	73																		
279	Unit of electronic circuit	317																		
280	Power cell	53																		
281	LC display panel	593																		
285	Rotor	37																		
701	Train wheel bridge	496																		
711	Center wheel cock	101																		
902	Buzzer contact spring	166																		
903	Friction spring for center wheel	99																		
922	Screw for power cell holder	127																		
922	Screw for unit of electronic circuit	128																		
922	Screw for train wheel bridge	○																		
922	Screw for setting lever spring	○																		
761	Power cell strap for checking	020																		

☆ For the reflecting plate, either one of the two types (silver and gold colors) is used.



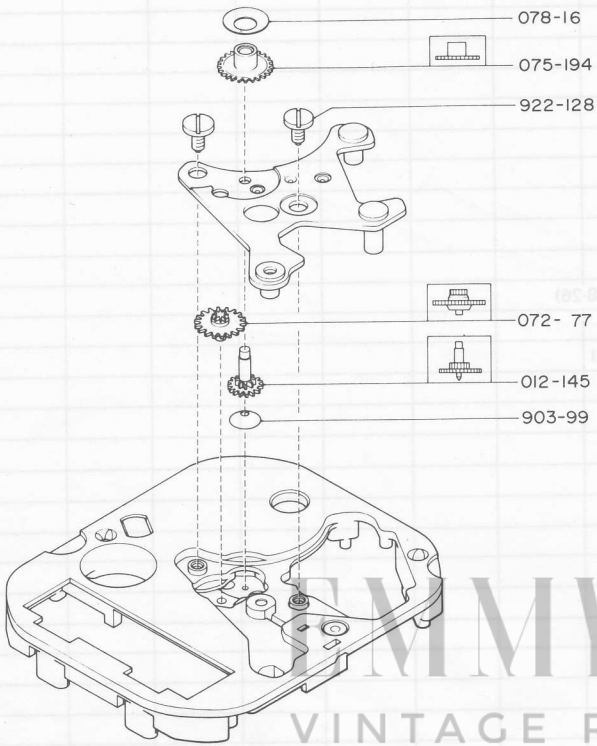

[Exploded View of Dial Side]

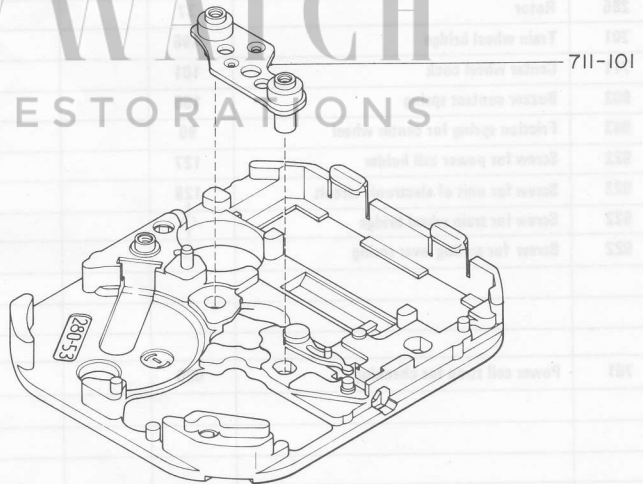

[Exploded View of Center Wheel Cock]

Parts No.	Caliber No.		8960
	Nos. of jewels		
Name of parts		02	
012	Center wheel and pinion	145	
072	Minute wheel & pinion	77	
075	Hour wheel	194	
078	Dial washer	16	
922	Screw for plate complete	128	

**Jewels**

Parts No.	Caliber No.		8960
	Nos. of jewels		
Name of parts		02	
942	Rotor/U	76	
942	Rotor/L	1	
950	3rd W/U	158	(Bush)