

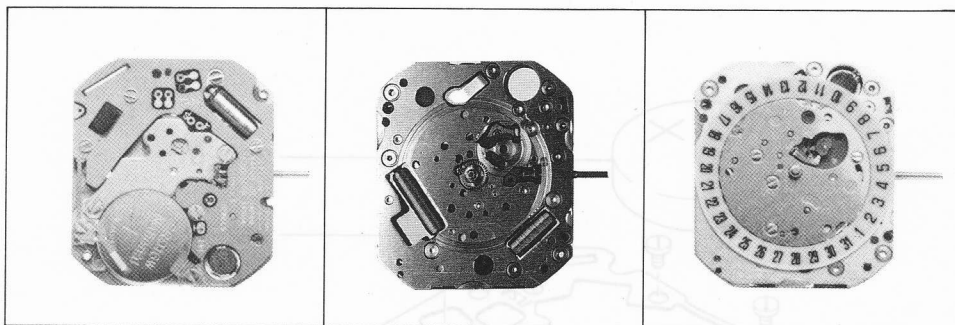

Citizen 3411,3413,3421,3430,3431,3451,3481 Movement Parts (1)

Compiled by EmmyWatch - <https://www.emmywatch.com>

Catalog No. 34-1 ~ 34-2



34-1
(Catalog No.)

34-2
(Catalog No.)

34-2
(Catalog No.)

3420A · 3421

- Analog quartz watch (without center second)
- Power saving switch
- Alarm (melody)
- Alarm monitor
- Electro magnetic correction method

Thickness: 2.0 mm

3411 · 3413

- Analog quartz watch (with center second)
- Date mechanism
- Date quick setting mechanism
- Power saving switch
- Alarm
- Alarm monitor
- Second stopping drive

Thickness: 2.5mm

3430 · 3431

- Analog quartz watch (with center second)
- Power saving switch
- Alarm (melody)
- Alarm monitor
- Second stopping drive

Thickness: 2.0mm

3450A · 3451

- Analog quartz watch (without center second)
- Date mechanism
- Date quick setting mechanism
- Power saving switch
- Alarm (melody)
- Alarm monitor
- Electro magnetic correction method

Thickness: 2.5mm

3480 · 3481

- Analog quartz watch (with center second)
- Electro magnetic correction method
- Second stopping drive

Thickness: 2.0mm

Size	20 x 23 x 26φmm
Oscillation per second	32,768Hz

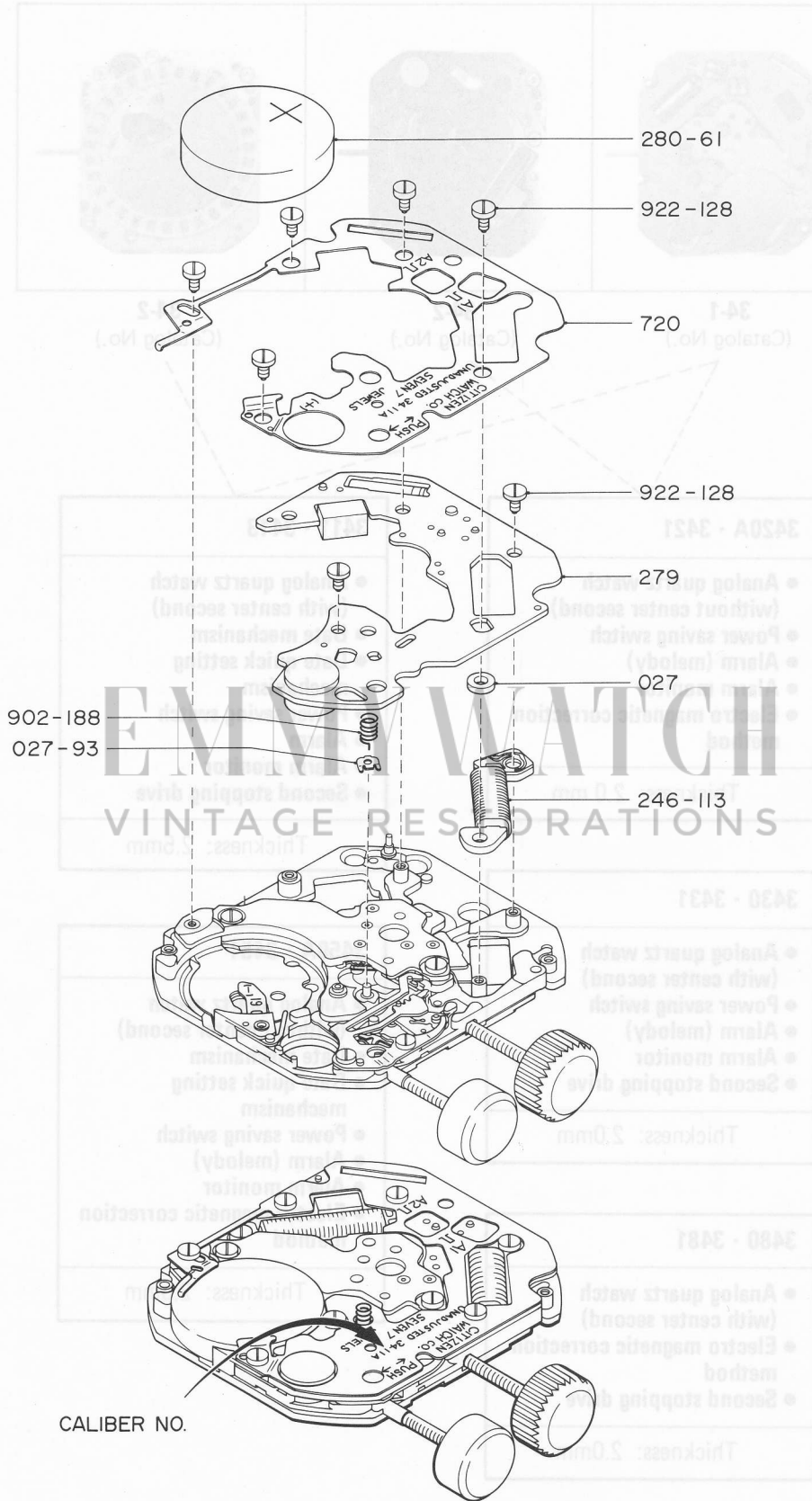

CALIBER NO.

Size	20 x 23 x 28mm
Oscillation per second	32,768Hz

Catalog No. 34-1-1

Parts No.	Name of parts	Caliber No.									
		3411	3413	3420	3421	3430	3431	3450	3451	3480	3481
		Nos. of jewels									
		07	07	03	03	07	07	03	03	09	09
027	Washer for buzzer contact spring	93	○	○	○	○	○	○	○		
027	Spacer for circuit unit supporter	94	○	○	○	○	○	○	○	○	○
027	Spacer for electronic supporter			95	○			95	○		
246	Coil unit	113	○	○	○	○	○	○	○	○	○
246	Second coil unit	114	○			114	○			114	○
279	Unit of electronic circuit	447	○	433	○	447	○	433	○	488	○
280	Power cell	61	○	○	○	○	○	○	○	○	○
720	Circuit unit supporter	075	116	076	117	089	118	067	119	097	120
902	Buzzer contact spring	193	○	188	○	193	○	188	○		
922	Screw for electronic circuit	128	○	○	○	○	○	○	○	○	○
922	Screw for circuit unit supporter	○	○	○	○	○	○	○	○	○	○
922	Screw for second coil unit	158	○			158	○			158	○
924	Screw for casing clamp	62	○	○	○	○	○	○	○	○	○

EMMYWATCH
VINTAGE RESTORATIONS

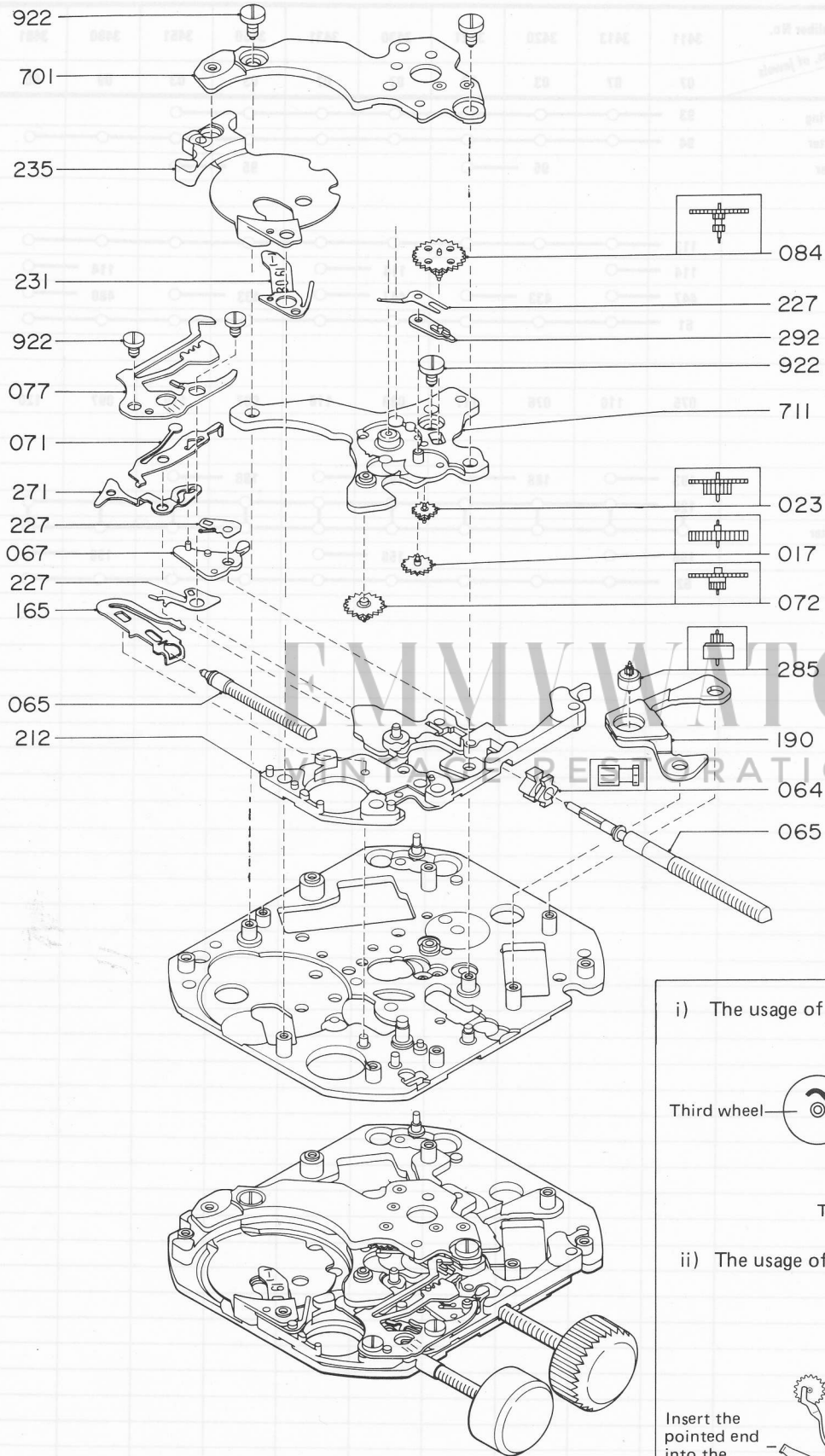

i) The usage of the third wheel strap

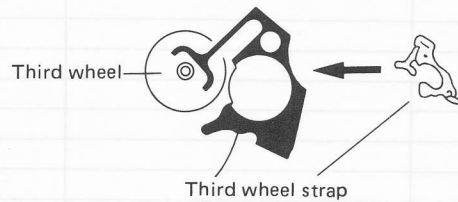

ii) The usage of the third wheel holder

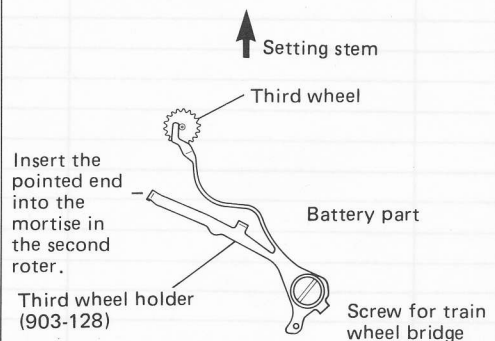

Catalog No. 34-1-2

Parts No.	Name of parts	Caliber No.									
		3411	3413	3420	3421	3430	3431	3450	3451	3480	3481
		Nos. of jewels									
		07	07	03	03	07	07	03	03	09	09
017	Third wheel and pinion	114	○	○	○	○	○	○	○	○	○
023	Fourth wheel	179	195	179	195	179	195	179	195	179	195
025	Second wheel	72	○			75	○			76	○
064	Clutch wheel	72	○	○	○	○	○	○	○	○	○
065	Setting stem	349	○	341	○	349	○	341	○	○	○
065	Switching stem	346	○	○	○	○	○	○	○		
067	Setting lever	161	○	○	○	○	○	○	○	166	○
071	Yoke	75	○	○	○	○	○	○	○	○	○
072	Minute wheel and pinion	82	○	○	○	○	○	○	○	○	○
077	Setting lever spring	106	○	104(106)	○	106	○	104(106)	○	106	○
084	Fifth wheel and pinion	26	45	26	45	26	45	26	45	26	45
087	Intermediate second wheel	51	○			51	○			51	○
165	Rocking bar	33	○	○	○	○	○	○	○		
190	Stater	61	○	○	○			○	○		○
190	Second stater	63	○			63	○			63	○
212	Spacer for setting stem	109	○	○	○	○	○	○	○	○	○
212	Spacer for yoke									127	○
227	Switch spring (I)	43	○	○	○	○	○	○	○	○	○
227	Switch spring (II)	44	○	○	○	○	○	○	○	○	○
227	Switch spring (III)	45	○	○	○	○	○	○	○	○	○
231	Power cell connector spring	143	○	○	○	○	○	○	○	○	○
235	Power cell connector	211	○	○	○	○	○	○	○	○	○
271	Date finger corrector lever	28	○					28	○		
285	Rotor	63	○	○	○	○	○	○	○	○	○
285	Second rotor	65	○			65	○			65	○
292	Switch lever	21	○	○	○	○	○	○	○	○	○
701	Train wheel bridge	527	○	528	○	527	○	528	○	551	○
711	Center wheel cock	112	122	113	123	112	122	113	123	119	125
903	Third wheel strap	124		124		124		124		124	
903	Third wheel holder		126		128		126		128		126
922	Screw for train wheel bridge	128	○	○	○	○	○	○	○	○	○
922	Screw for center wheel cock	158	○	○	○	○	○	○	○	○	○
922	Screw for setting lever spring	○	○	○	○	○	○	○	○	○	○

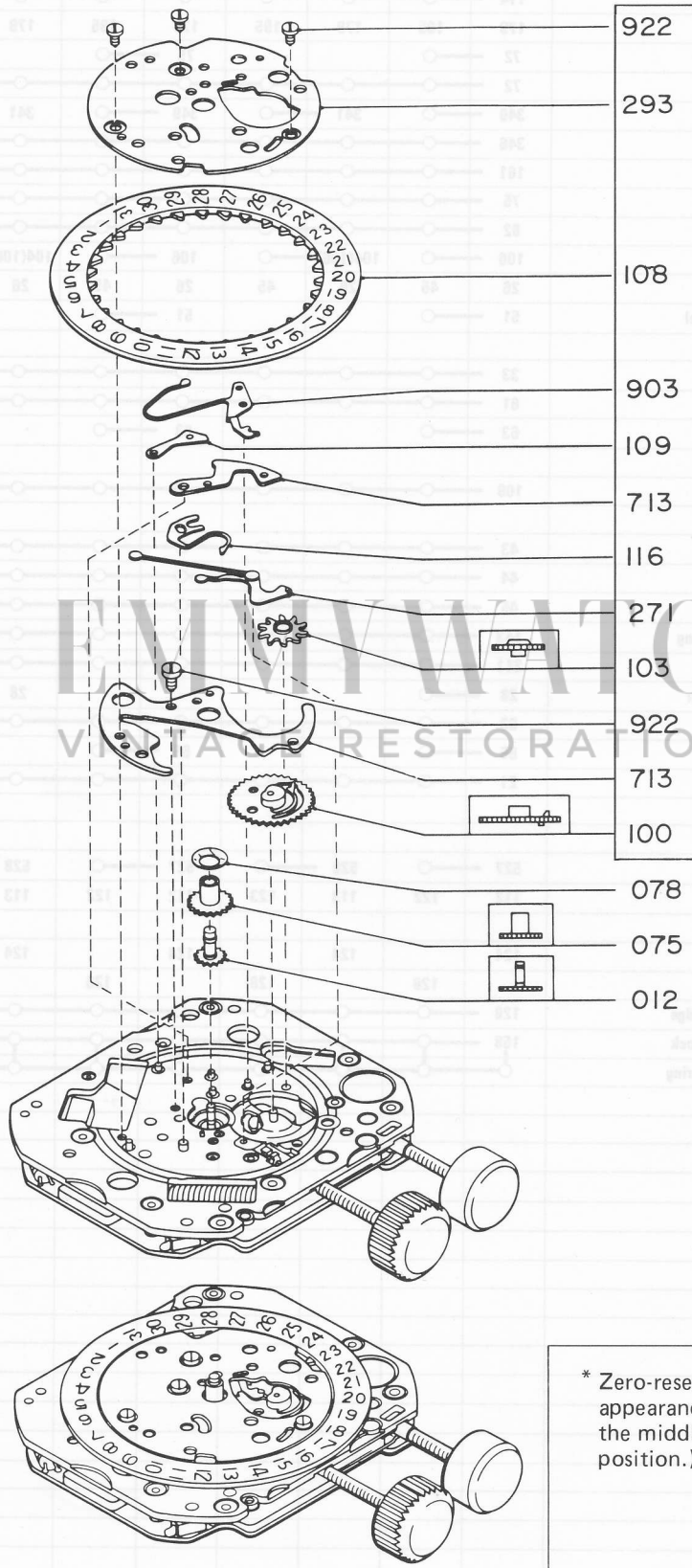

Exclusively used
in Cal. 3450

* Zero-resetting lever is one of the appearance parts. (it is located above the middle frame, near the 9 O'clock position.)

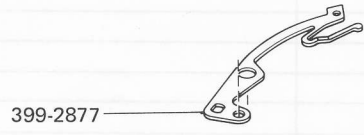

Catalog No. 34-2

Parts No.	Name of parts	Caliber No.									
		3411	3413	3420	3421	3430	3431	3450	3451	3480	3481
		Nos. of jewels									
		07	07	03	03	07	07	03	03	09	09
012	Center wheel and pinion	158	○	161	○	165	○	159	○	166	○
075	Hour wheel	222	○	237	○	○	○	222	○	243	○
078	Dial washer	21	○	○	○	○	○	○	○	○	○
100	Intermediate date wheel	22	○					22	○		
103	Date dial driving wheel	79	○					79	○		
109	Date jumper	46	○					46	○		
116	Calendar corrector lever	38	○					38	○		
271	Date corrector lever	29	○					29	○		
293	Date dial guard	73	○					73	○		
713	Date dial guard (I)	077	○					077	○		
713	Date dial guard (II)	078	○					078	○		
903	Spring for date jumper	109	○					109	○		
922	Screw for date dial guard (I)	82	○					82	○	○	○
922	Screw for date dial guard	159	○					159	○	○	○

EMMYWATCH
VINTAGE RESTORATIONS

Jewels

Parts No.	Name of parts	Caliber No.									
		3411	3413	3420	3421	3430	3431	3450	3451	3480	3481
		Nos. of jewels									
		07	07	03	03	07	07	03	03	09	09
941	5th W/U	57	○	○	○	○	○	○	○	○	○
941	Additional intermediate/U	72	○			72	○			72	○
941	Additional intermediate/L	○	○			○	○			○	○
942	Roter/U	76	○	○	○	○	○	○	○	○	○
942	Roter/L	○	○	○	○	○	○	○	○	○	○
942	Second rotor/U	○	○	○	○	○	○	○	○	○	○
942	Second rotor/L	○	○	○	○	○	○	○	○	○	○
950	4th W/L	161	○	○	○	○	○	○	○	○	○
950	5th W/L	○	○	○	○	○	○	○	○	○	○
950	Second W/U	181	○			181	○				