



EMMYWATCH
VINTAGE RESTORATIONS

Certina 25-021 Movement Parts (1)

Compiled by EmmyWatch - <https://www.emmywatch.com>

CERTINA

11½'''

Ancre - 17 ou 21 rubis
 Seconde au centre directe
 Quantième à guichet
 Correcteur - rapide
 Ah (Alternances horaires) 21600

Cal. 25-021

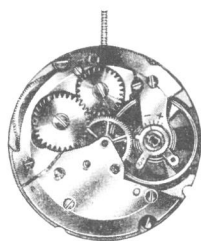

11½'''

Pallet-fork - 17 or 21 jewels
 Direct sweep second
 Date showing through aperture in dial
 Rapid corrector
 Ah (Alternations per hour) 21600

11½'''

Ancora - 17 o 21 rubies
 Segundero central directo
 Calendario con ventanilla
 Corrector - rapido
 Ah (Alternaciones horarias) 21600



11½'''

Anker - 17 oder 21 Rubine
 Direkte Zentrumssekunde
 Datum mit Fenster
 Schnellkorrektor
 Ah (Halbschwingungen pro Stunde) 21600

EMMY WATCH
 VINTAGE RESTORATIONS

11½'''

Ancora - 17 o 21 rubini
 Secondo al centro diretto
 Calendario a finestra
 Corrector - rapido
 Ah (Alternazioni orarie) 21600

Calibre de base
 Basic calibre
 Calibre de base
 Grundkaliber
 Calibro di base

25-02

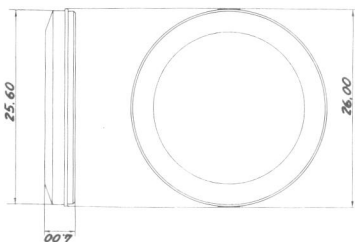

CERTINA

Pièces différentes du cal.
 Parts varying from cal.
 Piezas diferentes del cal.
 Teile, die verschieden sind vom Kal.
 Pezzi diversi da quelli del cal.

25-02

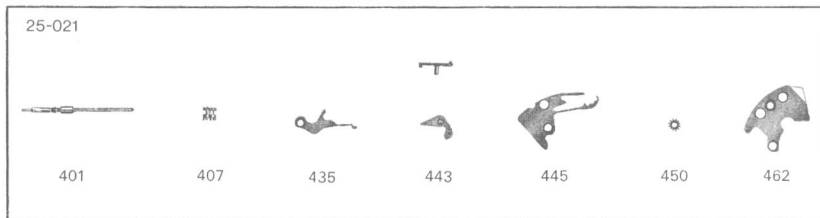
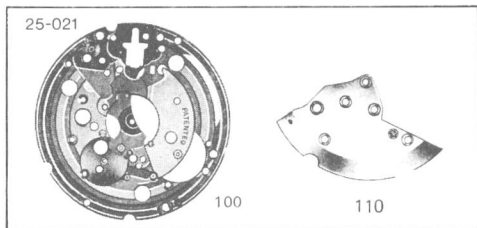

EMMYWATCH

VINTAGE RESTORATIONS

Pièces supplémentaires au cal.
 Additional parts to cal.
 Piezas suplementarias al cal.
 Zusätzliche Teile zu Kal.
 Pezzi supplementari al cal.

25-02

