



EMMYWATCH
VINTAGE RESTORATIONS

Certina 17-011 Movement Parts (1)

Compiled by EmmyWatch - <https://www.emmywatch.com>

Cal. 17-011

7 $\frac{3}{4}$ '''
 Ancre - 17, 21 ou 25 rubis
 Seconde au centre directe
 Automatique
 Quantième à guichet
 Correcteur - rapide
 Ah (Alternances horaires) 21600



7 $\frac{3}{4}$ '''
 Pallet-fork - 17, 21 or 25 jewels
 Direct sweep second
 Automatic
 Date showing through aperture in dial
 Rapid corrector
 Ah (Alternations per hour) 21600



7 $\frac{3}{4}$ '''
 Ancora - 17, 21 o 25 rubies
 Segundero central directo
 Automático
 Calendario con ventanilla
 Corrector - rápido
 Ah (Alternaciones horarias) 21600

7 $\frac{3}{4}$ '''
 Anker - 17, 21 oder 25 Rubine
 Direkte Zentrumsekunde
 Automatisch
 Datum mit Fenster
 Schnellkorrektor
 Ah (Halbschwingungen pro Stunde) 21600

7 $\frac{3}{4}$ '''
 Ancora - 17, 21 o 25 rubini
 Secondo al centro diretto
 Automatico
 Calendario a finestra
 Corrector - rapido
 Ah (Alternazioni orarie) 21600

EMMY WATCH
 VINTAGE RESTORATIONS

Calibre de base }
 Basic calibre }
 Calibre de base } 17-021
 Grundkaliber }
 Calibro di base }

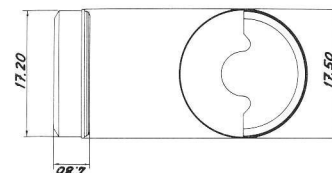

Pièces différentes du cal.
Parts varying from cal.
 Piezas diferentes del cal.
Teile, die verschieden sind vom Kal.
 Pezzi diversi da quelli del cal.

17-021

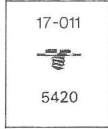
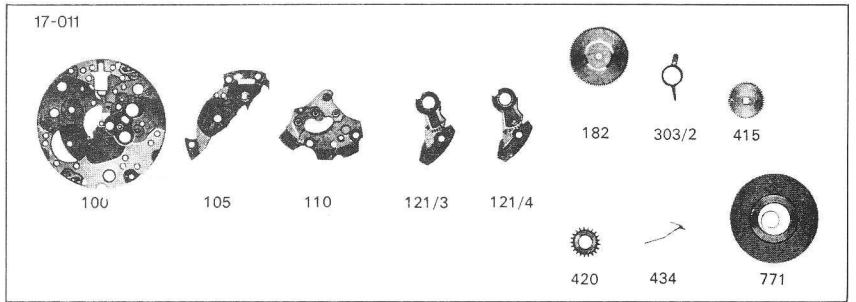

Pièces supplémentaires au cal.
Additional parts to cal.
 Piezas suplementarias al cal.
Zusätzliche Teile zu Kal.
 Pezzi supplementari al cal.

17-021

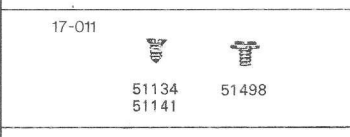

EMMY WATCH
 VINTAGE RESTORATIONS